

## REGIO

dry siphon anti-odour transparent and removable with aesthetic lid

11126322B - SCD3E0008

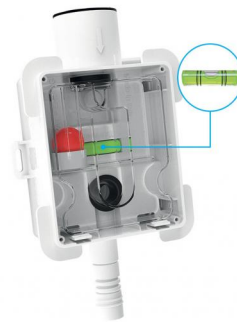

### TECHNICAL SPECIFICATIONS:

- Flow rate 60 l/h
- Pipe inlet dimensions from  $\varnothing$  16 to  $\varnothing$  28
- Drain pipe dimensions  $\varnothing$  21
- Top inlet is equipped with gasket
- Built-in spirit level
- Material: siphon in polystyrene, siphon box in polypropylene
- External ridge for installation flush with unfinished wall
- Suitable for wall installation or vertical sub-track installation
- Temperatura max dell'acqua in scarico 60°C

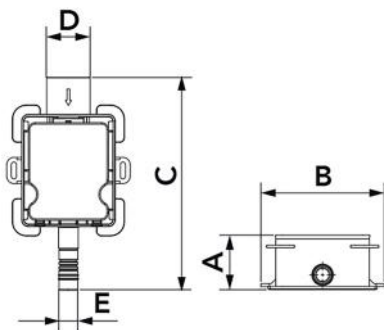

### DIMENSIONS

CODE	A [mm]	B [mm]	C [mm]	D [mm]	E [mm]
11126322B	55	120	230	46,5	21
SCD3E0008			--		

### TUBE OUTLET COUPLER COMPATIBLE WITH:

- Rigid condensate drain pipe TCR-21 with MG coupling sleeve
- Condensate drain pipe  $\varnothing$  40 - 36 - 32 - 28 with MG adapter sleeve
- Condensate drain pipe  $\varnothing$  20 double cladding sleeves  $\varnothing$  18/20
- Condensate drain pipe reinforced by under-track  $\varnothing$  20 single cladding with o-ring
- Blue condensate drain pipe reinforced by under-track  $\varnothing$  20 single cladding - sleeves  $\varnothing$  18/20

## PACK COMPLETE WITH

- Siphon box with built-in level
- Protective cover for the construction phase
- Rubber seal for piping inlet
- Transparent siphon
- Aesthetic finish lid

## ITEMS

CODE	DESCRIPTION
11126322B	CLEAR REMOVABLE ODOUR-STOP WATERLESS TRAP "REGIO" WITH ATTRACTIVE COVER
SCD3E0008	