

EXCELLENS T

standard duct

11120060 - 11120072 - 11120010
 N11120060 - N11120072 - N11120010
 E11120060 - E11120072 - E11120010
 SCD100006 - SCD100008 - SCD100051
 SCD100053 - SCD100184

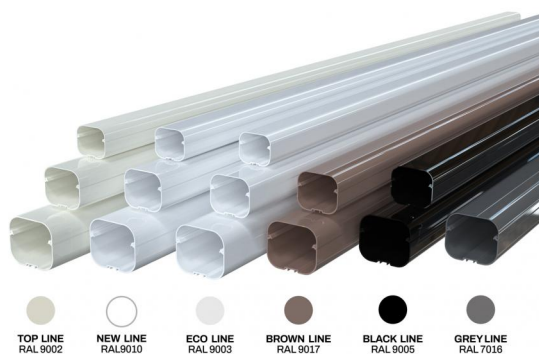

TECHNICAL SPECIFICATIONS:

- Stiff, shockproof, anti-UVA and recyclable PVC
- Rounded bottom and lid
- Clip-together central fastening
- Pre-punched slots in bottom for wall mounting
- Prepared for insertion of the mini pumps Easy Flow, Easy One, Aqua Split (only model T 72-EXC)
- Length 2 m
- Paintable
- Operating temperature -20°C / +60°C

MODELS AVAILABLE:

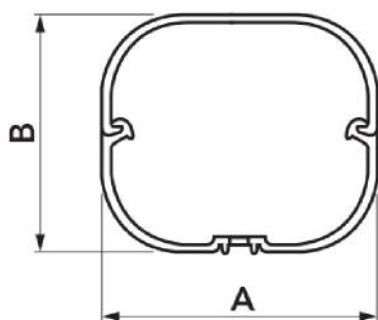

DIMENSIONS

CODE	MODEL	LINE	A [mm]	B [mm]
11120060	T 60 - EXC	TOP LINE	60	52
11120072	T 72 - EXC	TOP LINE	72	64
11120010	T 100 - EXC	TOP LINE	98	73
N11120060	T 60 - EXC	NEW LINE	60	52
N11120072	T 72 - EXC	NEW LINE	72	64
N11120010	T 100 - EXC	NEW LINE	98	73
E11120060	T 60 - EXC	ECO LINE	60	52
E11120072	T 72 - EXC	ECO LINE	72	64
E11120010	T 100 - EXC	ECO LINE	98	73
SCD100006	T 72 - EXC	BROWN LINE	72	64
SCD100008	T 100 - EXC	BROWN LINE	98	73
SCD100051	T 72 - EXC	BLACK LINE	72	64
SCD100053	T 100 - EXC	BLACK LINE	98	73
SCD100184	T 72 - EXC	GREY LINE	72	64

ITEMS

CODE	DESCRIPTION
11120060	T 60-EXC - "EXCELLENS T" LINE STANDARD TRUNKING - 2 mt. long
11120072	T 72-EXC - "EXCELLENS T" LINE STANDARD TRUNKING - 2 mt. long
11120010	T 100-EXC - "EXCELLENS T" LINE STANDARD TRUNKING - 2 mt. long
N11120060	T 60-EXC - "EXCELLENS T" LINE STANDARD TRUNKING - 2 mt. long
N11120072	T 72-EXC - "EXCELLENS T" LINE STANDARD TRUNKING - 2 mt. long
N11120010	T 100-EXC - "EXCELLENS T" LINE STANDARD TRUNKING - 2 mt. long
E11120060	T60-EXC - "EXCELLENS T" LINE STANDARD TRUNKING - 2 mt. long
E11120072	T72-EXC - "EXCELLENS T" LINE STANDARD TRUNKING - 2 mt. long
E11120010	T100-EXC - "EXCELLENS T" LINE STANDARD TRUNKING - 2 mt. long
SCD100006	T 72-EXC - *TRUNKING "EXCELLENS" T 72-EXC - BROWN LINE" (8 pcs)
SCD100008	T 100-EXC - *TRUNKING "EXCELLENS" T100-EXC - BROWN LINE" (5pcs)
SCD100051	T 72-EXC - *TRUNKING "EXCELLENS" T 72-EXC - BLACK LINE" (8 pcs)
SCD100053	T 100-EXC - *TRUNKING "EXCELLENS" T 100-EXC - BLACK LINE" (5 pcs)
SCD100184	"EXCELLENS T" LINE STANDARD TRUNKING - 2 mt. long - ANTHRACITE GREY