

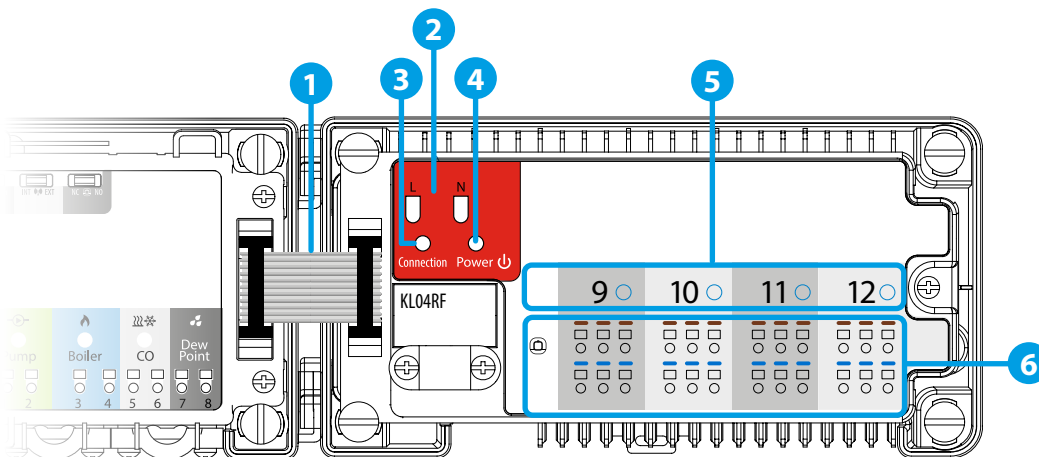

Wiring Centre Description

1. Serial Connector
2. Power Supply
3. Connection diode
4. Power supply diode
5. Work status indication of each zone
6. Output terminals for actuators



DISTRIBUTOR OF SALUS CONTROLS:

QL CONTROLS Sp. z o.o., Sp. k.

Rolna 4,
43-262 Kobielce,
Poland

Importer:

SALUS Controls Plc
Units 8-10 Northfield Business Park
Forge Way, Parkgate, Rotherham
S60 1SD, United Kingdom



www.salus-controls.eu

SALUS Controls is a member of the Computime Group.

Maintaining a policy of continuous product development SALUS Controls plc reserve the right to change specification, design and materials of products listed in this brochure without prior notice.



Introduction

The KL04RF module is an extension to the KL08RF wiring centre for an additional 4 heating zones. Works only in combination with KL08RF wiring centre and increases its functionality up to 12 individual heating zones.

Product Compliance

This product complies with the essential requirements and other relevant provisions of the following EU Directives: EMC 2014/30/EU, Low Voltage Directive LVD 2014/35/EU, Radio directive 2014/53/EU and RoHS directive 2011/65/EU. The full text of the EU Declaration of Conformity is available at the following internet address: www.saluslegal.com

Safety Informations

Use in accordance with national and EU regulations. Device is intended for indoor use only in dry conditions. Installation must be carried out by a qualified person in accordance to national and EU regulations.

Before attempting to setup and install, make sure that KL04RF is not connected to any power source. Installation must be carried out by a qualified person. Incorrect installation may cause damage to the wiring centre. The KL04RF should not be installed in areas where it may be exposed to water or damp conditions.

Technical Information

| | |
|-----------------|---------------------------------|
| Power Supply | 230 V AC |
| Max load | 3 A |
| Outputs | Thermoelectric actuator 230V AC |
| Dimensions [mm] | 163 x 85 x 67 |

1. Serial connector

It is used for communication between KL08RF wiring centre and KL04RF extension module. Combined set increases support up to 12 zones.

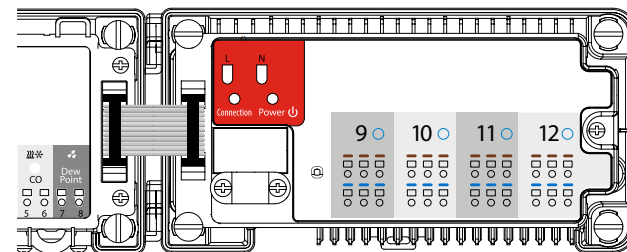

2. Power supply

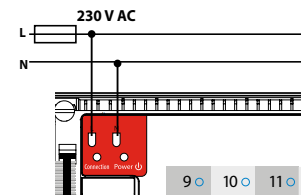

Power supply for wiring centre is 230V ~, 50Hz.

- Features of the installation:
- two-wire, with PE protective conductor,
 - made in accordance with applicable regulations.

3. Connection diode



If KL04RF module is properly connected to the KL08RF wiring centre, connection diode will light solid red.

4. Power supply diode



After connecting the KL04RF module to the power supply, Power led diode will light solid red.

5. Work status indication of each zone

Green led diode lights up when the heating demand signal is being transmitted from the thermostat to the given zone (with NC actuators connected).

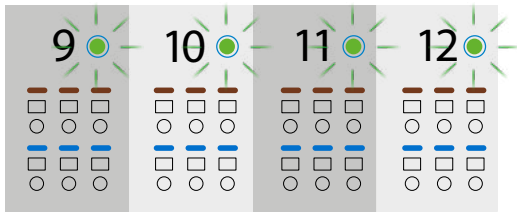

6. Output terminals for actuators

Wires of the thermoelectric actuators should be plugged into the self-locking connectors in the appropriate zones. You can connect 3 actuators directly to one zone. The current load of one zone is adapted to operate with up to 6 thermoelectric actuators with a power of 2 Watts. If there is a need to connect more than 6 actuators please use an additional relay to relieve the output of the zone.

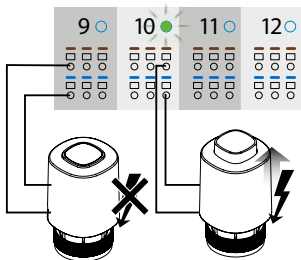

The operation was explained on the example of T30NC actuators.



Note: On the actuator contacts, there is voltage 230 V AC during their work.

INSTALLATION

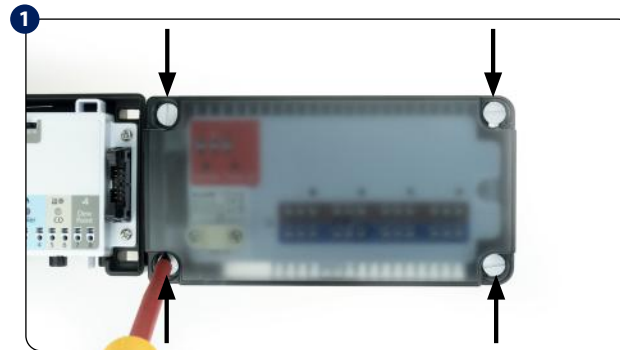

Remove the top cover of the KL04RF.



Mount the back side of the housing to the wall.
When mounting on a DIN rail, open the hooks on the back of the housing.

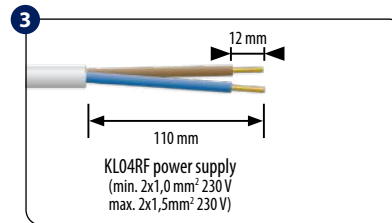

KL04RF power supply
(min. 2x1,0 mm² 230 V
max. 2x1,5mm² 230 V)

Remove the appropriate piece of insulation from the wires.

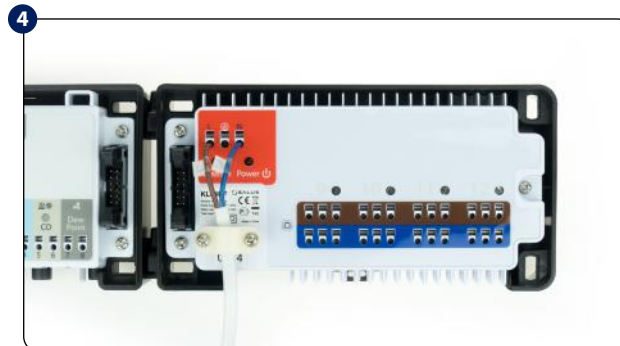

Thread the power supply wires through and connect them to the "L" and "N" terminals.

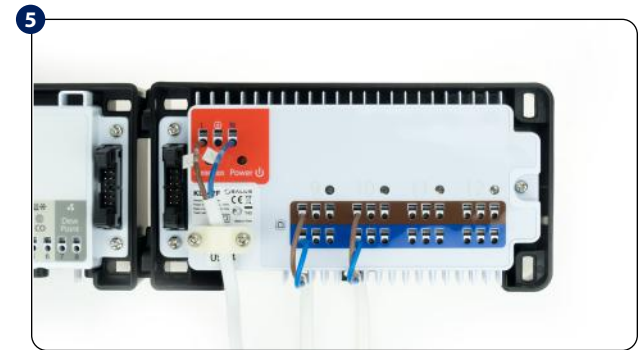

Connect the thermoelectric actuators wires.

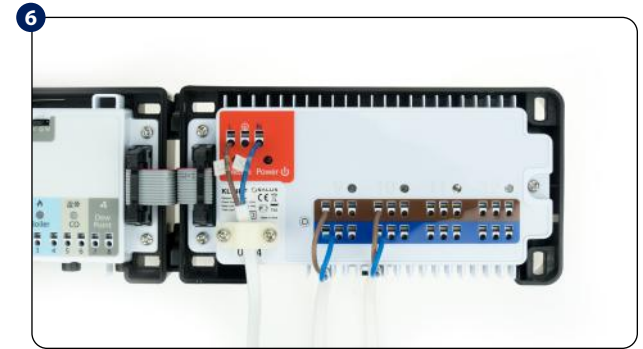

Connect KL08RF and KL04RF using serial connector.



Make sure that all the wires are properly connected, mount top cover and power up the wiring centre - "Power" and "Connection" red LED diodes will light up indicating the correct connection with the KL08RF wiring centre.