



CONTROL SYSTEMS

FOR YOUR NEEDS

 **SALUS**[®]
CONTROLS



WATER LEAK SENSOR



This sensor was created to detect leaks in plumbing installations.

Features:

- Waterproof
- Wireless connectivity (ZigBee)
- Small size
- LED diode - indicates the device status
- Many assembly possibilities through the accessories included in the kit

Power Supply	3 V (CR2 battery)
Length of the external sensor	2 m
Sensor dimensions [mm]	H=25, Ø=55
Housing dimensions [mm]	60 x 66 x 30



< Feel safe

Water leak sensor helps to minimize the damages and potential renovation costs caused by flood (flooded rooms/equipment).

It informs about plumbing installation failure, floods, roof leaks, etc.

Water leak sensors can be a good complement of an expanded alarm system (monitoring, alarming).

Examples of use:



Bathroom



Kitchen



Boiler room



Warehouse



Archive room



Production hall

SALUS Smart Home

Water leak sensor is part of the **SALUS Smart Home system**, thanks to it we have access to an infinite number of configurations and application options.

System can prevent losses by **cutting off the water supply** using devices like SR600 or SPE600.

It is also possible to **send notifications** (SMS, e-mail) at the time when an alarm is triggered by the water leak sensor.





WATER LEAK SENSOR

Example of use:

1. Water leak sensor contacts are shorted by liquid
2. Sensor sends a signal to the UGE600 gateway
3. The UGE600 gateway sends an SMS notification and closes the valve by SPE600 Smart Plug

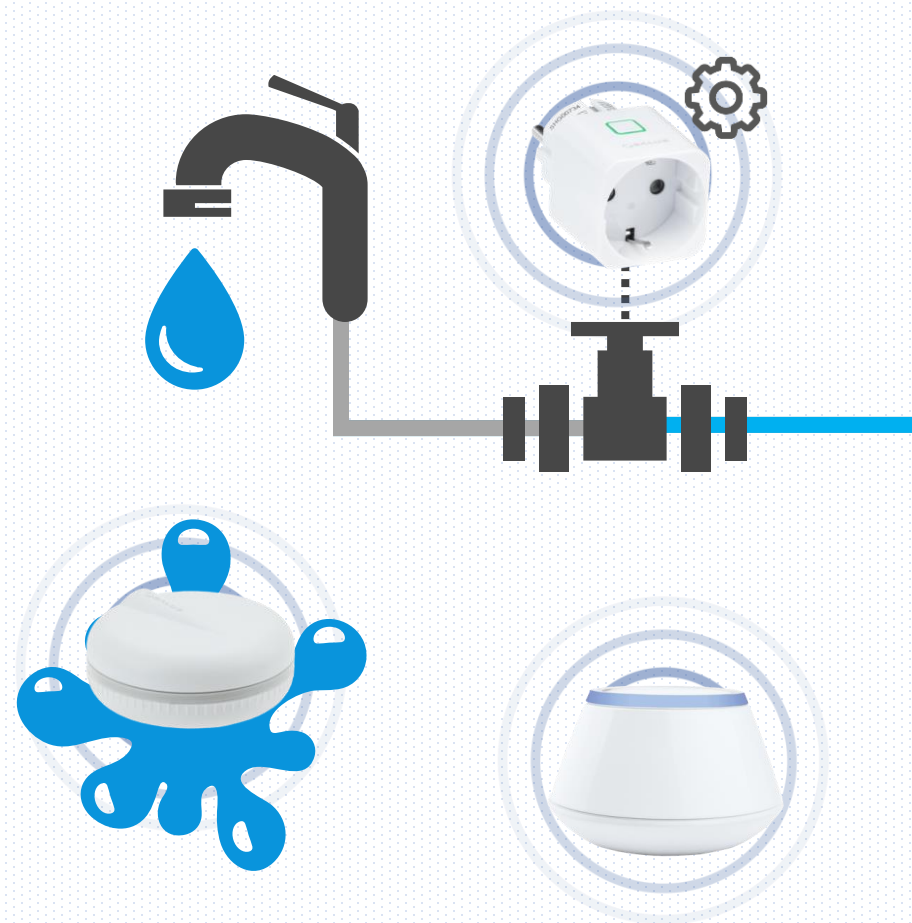

Water leak sensor set contains:



Water leak sensor



External sensor



Holder



Mounting accessories
(screws + self-adhesive tape)

+ Manual Instruction

Many assembly possibilities:

1. As a standalone water leak sensor



Contacts for leak detection

Many assembly possibilities:

2. Water leak sensor + holder



Contacts for leak detection

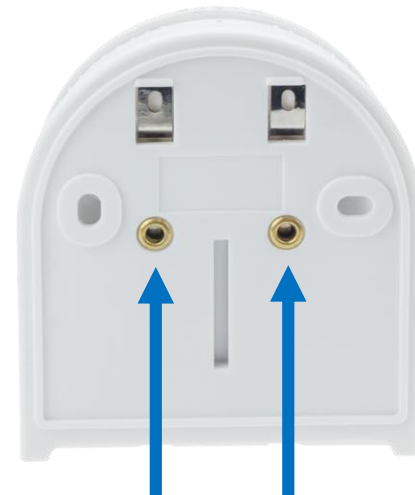

Contacts for leak detection

Many assembly possibilities:

2. Water leak sensor + holder

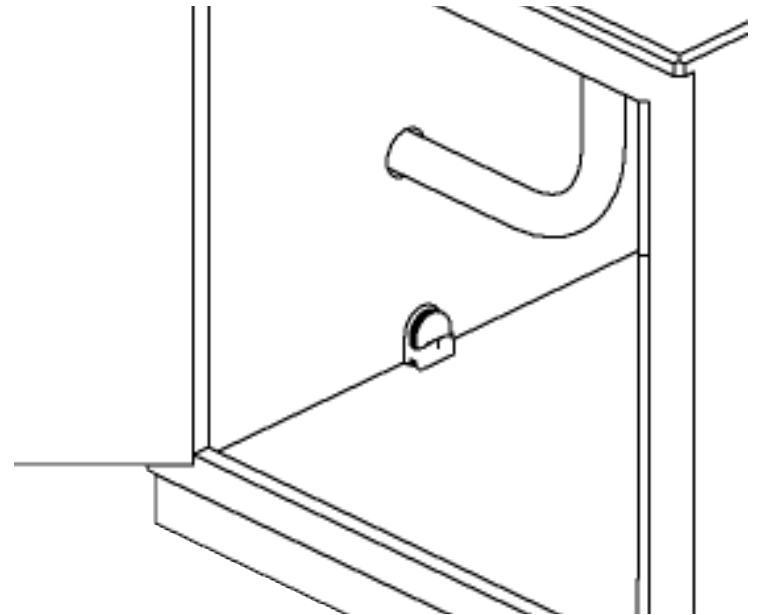
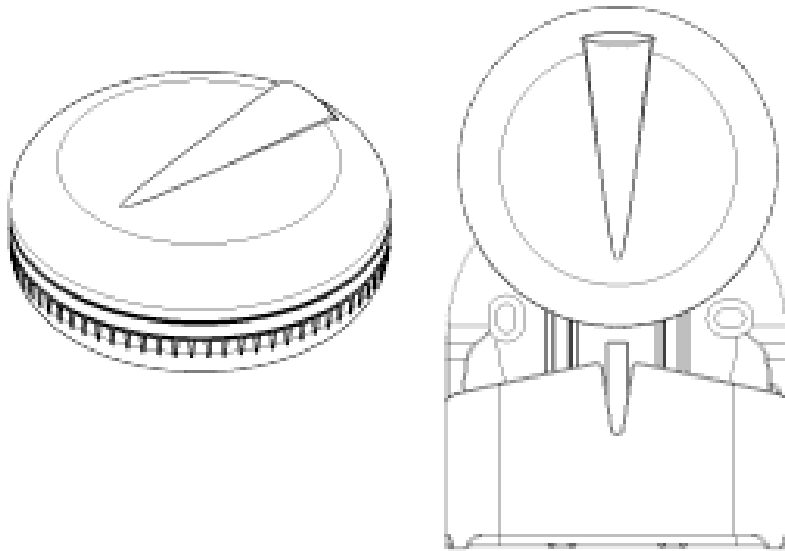

Many assembly possibilities:

3. Water leak sensor + holder + external sensor



Contacts for leak detection



Many assembly possibilities:

3. Water leak sensor + holder + external sensor

Flat surface assembly

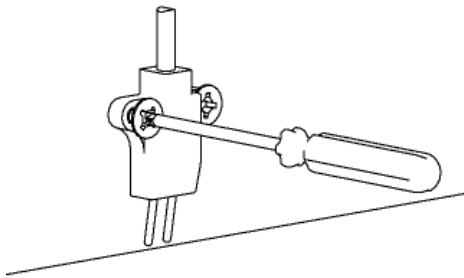

Assembly by cable tie

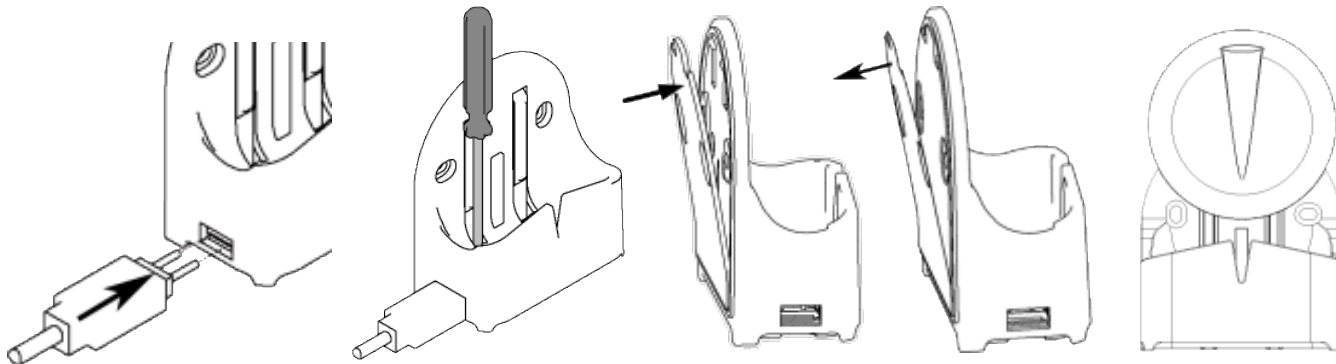
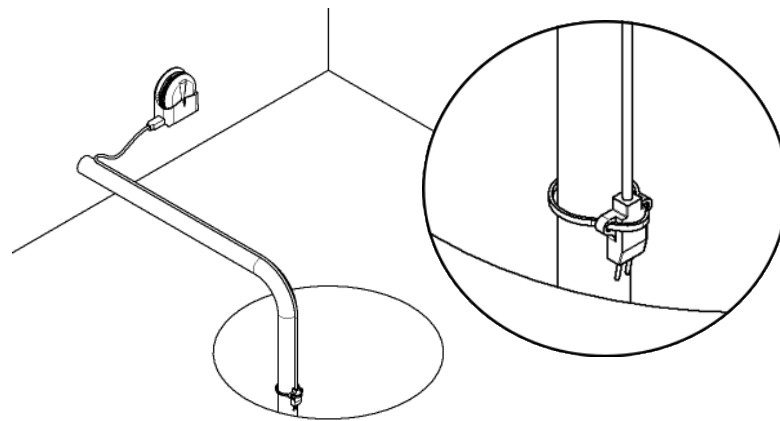

A faded, grayscale background image showing a person's hands holding a smartphone over an open laptop, suggesting a professional or technical environment.

**For more information on SALUS Controls products,
please visit:**

www.salus-controls.eu

and **www.it600.eu**